

88814812 ....88814807....09124092143

# MULTI-FUNCTION LAMINATOR

## OPERATING INSTRUCTIONS



گروه مهندسی سیف لند

## "LAMINATOR Series" OPERATIONAL MANUAL

### INTRODUCTION

Congratulations on the purchase of your new **LAMINATOR** a heavy duty pouch laminator. Your **LAMINATOR** was specially designed with the highest available technology and premium quality components, to render you a high quality lamination, as many years of trouble-free service. The **LAMINATOR** can operate with any standard laminating pouch currently in the market. It was specially designed to operate with or without a carrier. Note: we only recommend the use of carriers with inferior quality pouches (high adhesive composition i.e. 10 mils(4/6) pouches), as they may excrete excessive adhesive, which can potentially damage the system.

### INTRODUCTION

We recommend that you take a few minutes to familiarize yourself with the functions of your new **LAMINATOR**. You will find out that with just a little practice, any person can achieve a professional lamination.

### FEATURES

1. Temperature control
2. Laminating/Cold control
3. Reverse Control
4. "ON" switch
5. "Heat" light
6. "ON" light
7. Exit
8. Entrance

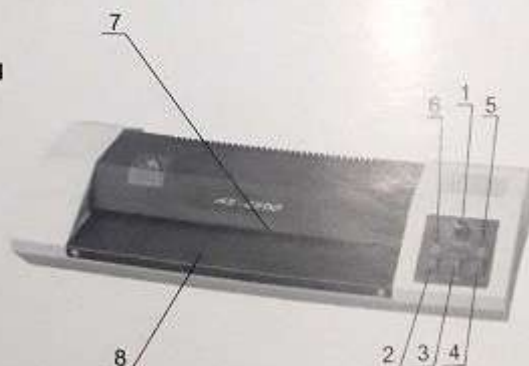

## OPERATION

1. Place your new **LAMINATOR** on top of a working table and plug power to a grounded 220v outlet (110v for certain Countries).
2. Turn the **Temperature control** to the desired position. Remark: Pouch thickness,paper type,pouch size or pouch Quality may require different temperature settings.
3. Press the "ON" switch.The "ON" light will turn on indicating that the **LAMINATOR** has been activated.
4. The "Heat" light will turn on in approximately 2-3 minutes, letting you know that the **LAMINATOR** is ready to start laminating.
5. Introduce the document to be laminated into the pouch,then introduce the pouch (sealed side first) into the entrance of the **LAMINATOR**.Do not past or press the pouch;the hested rollers will automatically take and transport the pouch. If the document was improperly inserted (at an angle) and there is a risk of jamming,press "OUT" on the **Reverse Control** immediately.Wait until the document is fed back Out completely. Press "IN" to continue with normal lamination.
6. Remove the pouch from the exit of the **LAMINATOR**. and Let it sit for a few seconds as it cools down.

## IMPORTANT

- a) If the pouch is not sealed or it appears very milky, the pouch or paper type requires more heat. Correct this by turning (Increasing) the temperature clockwise. Wait a minute or two until the heat light turns on.Proceed to laminate.Repeat this Step as needed.



- b) If the pouch is curled or wavy, the temperature is too high. Correct this by turning (decreasing) the temperature Counterclockwise. Wait a minute or two. Proceed to laminate. Repeat this step as needed.
- c) The **LAMINATOR** is designed to work with all standard Pouches. However, certain pouch brands contain high adhesive composition levels or very delicate adhesives, as a result these pouches may excrete excessive adhesive through the sides upon meltin. If you are using these types of pouches, we strongly recommend the use of a carrier when laminating. This will avoid over-dirtying of the rollers.
- d) The **LAMINATOR** is designed to work with any standard pouch, with or without the use of a pouch carrier. However, certain pouch brands are made with higher heat melting adhesives or higher polyester compositions. If you are using these types of pouches and if the equipment is already set at its highest temperature level and the pouch is still not sealed or it appears milky after running it through, then avoid using a carrier as this will reduce the need for more heat by 35°F to 55°F and will allow you to obtain the proper lamination.
- e) The **LAMINATOR** is designed to work with any standard pouch thickness. With or without the use of a pouch carrier. However, in some cases the pouch may be introduced wrongly by the operator or at a higher heat, If this occurs and the operator does not react to use the reverse function, the pouch may become stuck inside the equipment. In extreme cases the pouch may get pushed into the heating lamps and burn. If this occurs do not panic, simply press the

Reverse function and pull the remanding pouch out. Let the rollers cool off and clean them. If smoke persists, it may be necessary to clean the heating lamps. Never clean while hot or while plugged to an electric outlet.

- ◆ For **Cold lamination**: Simply press "COLD" on the laminating system control. If the **LAMINATOR** is hot, wait a minute or two before laminating.
  
- 7. Turn the **LAMINATOR** off once you are finished laminating.

### REMARKS

- If you will continue to laminate shortly leave the **LAMINATOR** On. This will allow to continue laminating without having to wait for the warm-up time.
- If you will not laminate for a long period of time, we recommend that you turn off your **LAMINATOR**, this will save energy and increase the equipment's life span.

### PRECAUTIONS

- Always turn "off" the LAMINATOR if you will stop laminating for long periods of time.
- To reduce the risk of electric shock, do not operate the **LAMINATOR** near water.
- Do not use the LAMINATOR if power cord is damaged.
- Do not allow the electric cord to be in contact with hot surfaces.
- In case of malfunction, return the unit to your distributor for service. This laminator does not contain any part that can be serviced by the consumer.

Model	Laminating Width (mm)	Laminating Speed (m/min)	Laminating Temperature (W)	Power Consumption (W)	Dimension (mm)	Weight (kg)
120	120	0.2	100-160	230	220×160×90	2.4
160B	160			320	260×160×90	2.8
160	160	0.5	100-160	320	340×200×110	5.3
220	220			420	400×200×110	6.2
260	260			520	440×200×110	6.8
√230C	240			420	400×240×105	6.5
320	320	0.5	100-180	620	500×220×110	7.7
330B	330			620	500×220×110	8
√330C	330	0.5	80-180	620	500×240×105	8.5
390	390	0.5	100-180	720	570×200×110	8.9
450	450			820	630×200×110	11
550	550	0-0.6		920	730×230×160	20
650	650			1100	830×230×160	24
230CN	230	0.5	80-180	320	425×240×105	6.5
330CN	330	0.5	80-180	420	525×240×105	8.5
450CN	450	0.5	80-180	520	645×240×105	12

## Electric Diagram

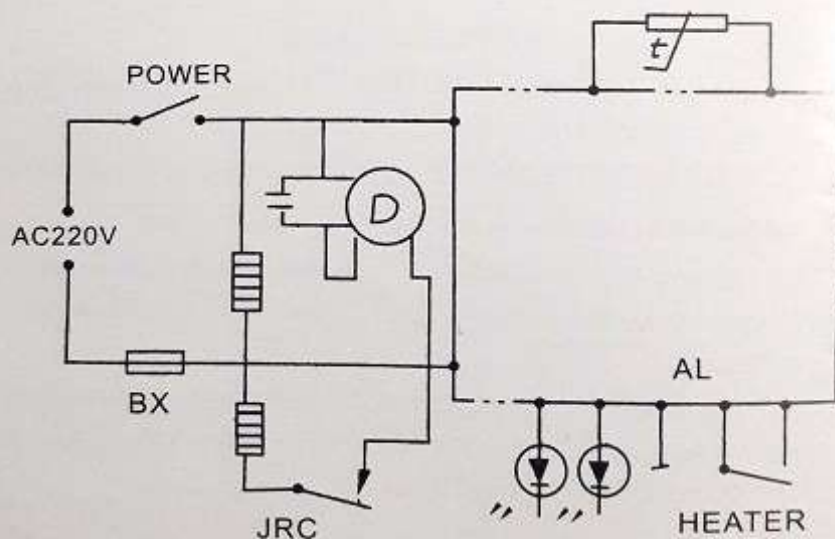



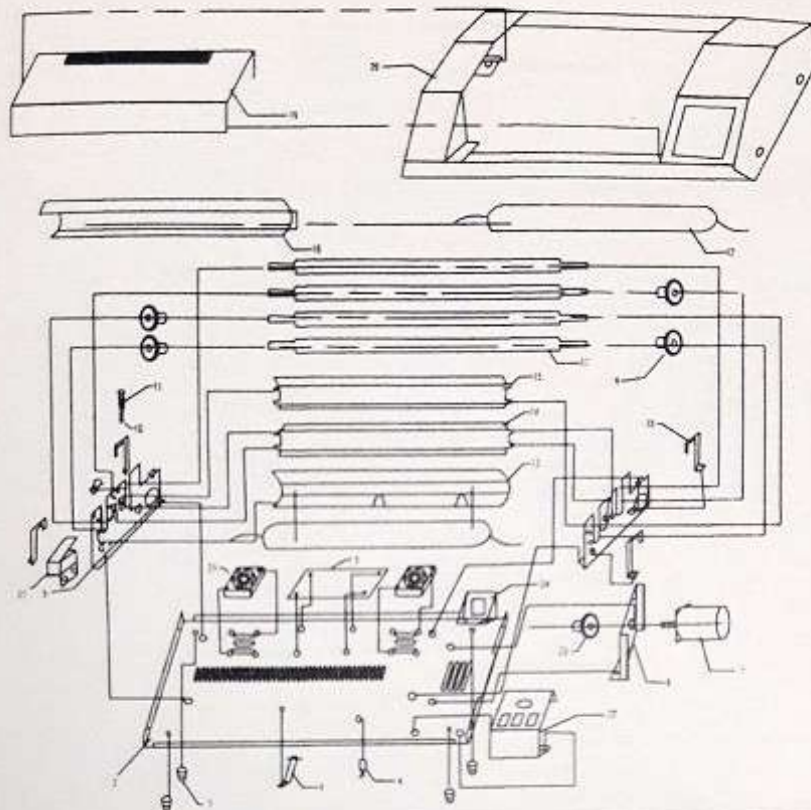

1	Rubber foot	14	Down educe plate
2	Bottom plate(metal)	15	Up ednce plate
3	Main P.C.B	16	Up cover
4	Heat protecter	17	Roller
5	Resistance	18	Press hook
6	Motor bracket	19	Cover
7	Motor	20	Cover shell
8	Roller bracket	21	Fan
9	Gear	22	Control panel
10	Bed spring	23	Motor gear
11	Spring screw	24	Power
12	Heater	25	Speed protector
13	Down cover		

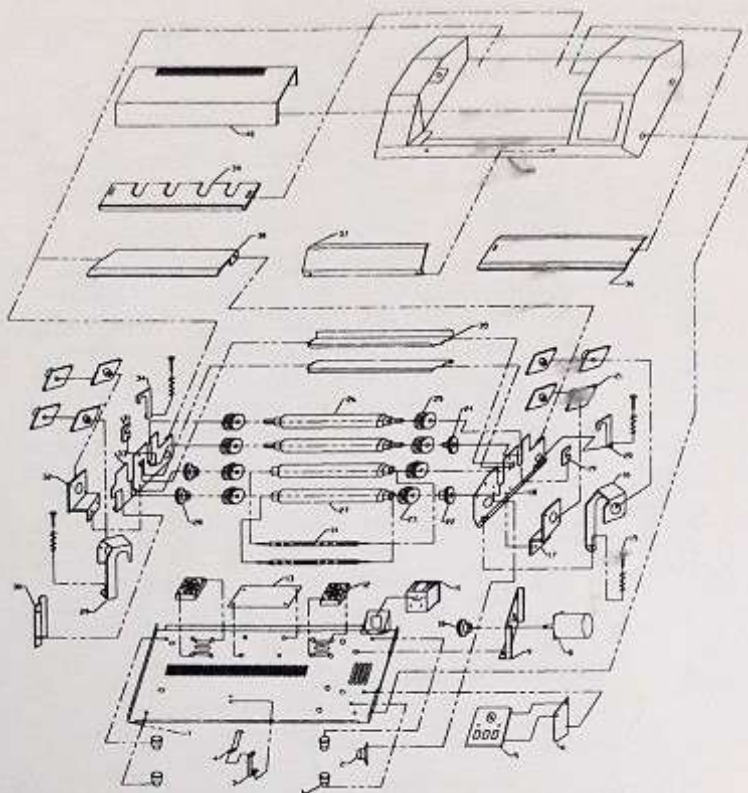

- |  |                                       |
|--|---------------------------------------|
| 1 Rubber foot                          | 22 Front roller active gear           |
| 2 Thermostat                           | 23 Front roller bushing               |
| 3 Thermistor bracket                   | 24 Rear roller active gear            |
| 4 Thermistor                           | 25 Rear roller bushing                |
| 5 Control panel                        | 26 Rear roller                        |
| 6 Control panel bracket                | 27 Front roller                       |
| 7 Base plate                           | 28 Front roller passive gear          |
| 8 Motor                                | 29 Left press hook of front roller    |
| 9 Motor bracket                        | 30 Thermal fuse press pad             |
| 10 Motor gear                          | 31 Left press pad of rear down roller |
| 11 Pluk socket                         | 32 Left bracket of heating lamp       |
| 12 fan                                 | 33 Left roller bracket                |
| 13 Main P.C.B                          | 34 Left press hook of rear roller     |
| 14 Heating lamp                        | 35 Middle educe plate                 |
| 15 Spring screw                        | 36 Hot insulating plate               |
| 16 Right press hook of front roller    | 37 Feed plate                         |
| 17 Right bracket of heating lamp       | 38 Down exit plate                    |
| 18 Right roller bracket                | 39 Up exit plate                      |
| 19 Right press pad of rear down roller | 40 Small cover                        |
| 20 Right press hook of rear roller     | 41 Body cover                         |
| 21 Insulating pad                      |                                       |